



## COMPANY PROFILE



**PT. VERTEX PLASTIK INDONESIA**



# ABOUT COMPANY

## COMPANY HISTORY

PT. Vertex Plastik Indonesia establish on November 2019, in response to market needs of professional & reliable trading company to supply variety of goods. Besides providing supply goods to meet client's various needs, our company are committed to delivery excellent products & services.

Our services included wholesale of machinery, equipment & supplies from trustworthy domestic & foreign company. Our team have dedicated, qualified, trained, licensed and good management to provide excellent & fast services to client's.

## COMPANY DETAIL

Name Of Company :  
PT. Vertex Plastik Indonesia

Address of Registered business :  
Factory B2 Lot 3, Panbil Industrial  
Estate, Kel. Muka Kuning, Kec.  
Sei Beduk, Kota Batam, Prov  
Kepulauan Riau

Company Registration No :  
9120111220466

Tax identity Number :  
93.494.150.1-225.000

### VISION

To become a trading company  
with the best service

### MISSION

To provide service that will exceed  
the expectations of our clients



## STRUCTURE ORGANIZATION

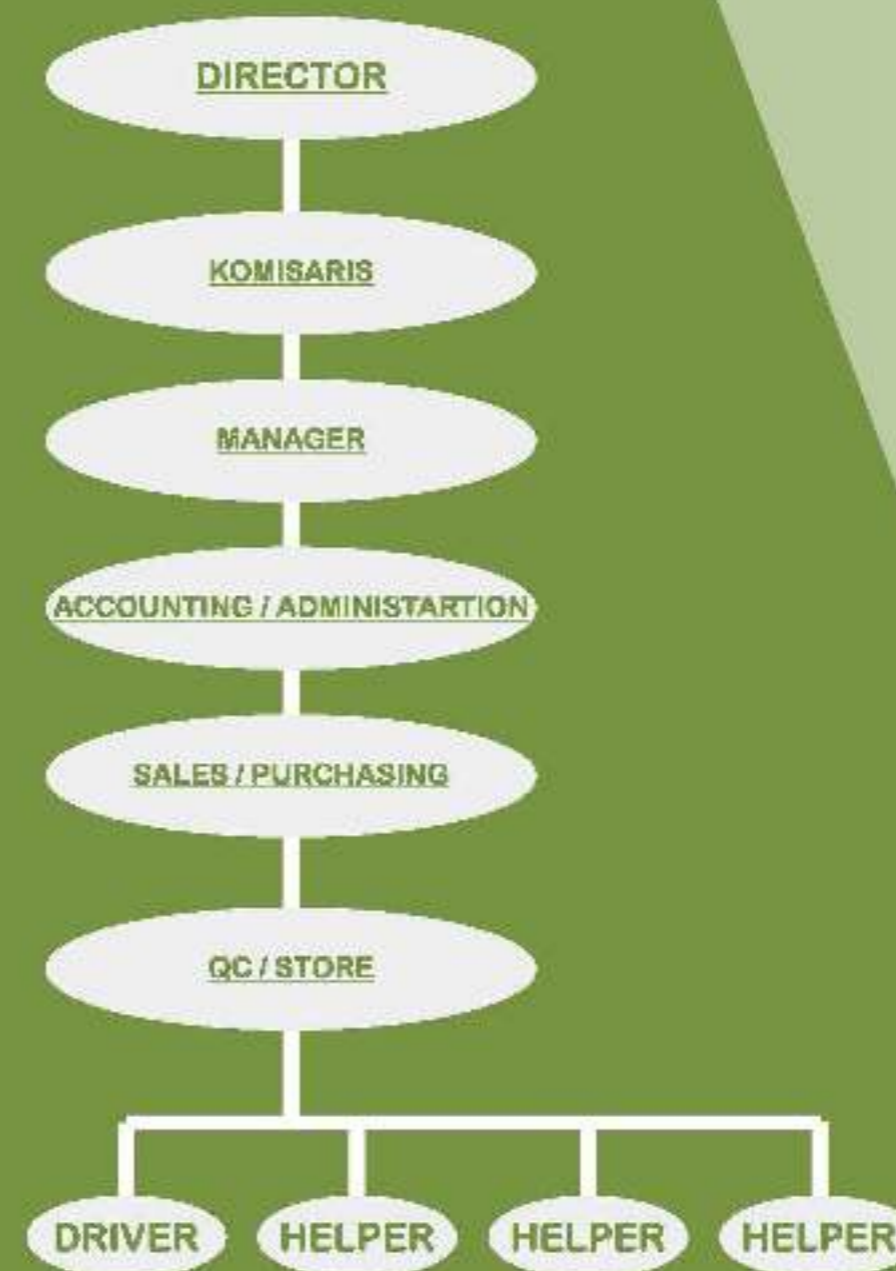



# OA

## CABLE TRUNKING

### Introduction

Cable trunking is a fully enclosed cable tray. It is most suitable for laying computer cables, communication cables, thermocouple cables and other control cables of highly sensitive systems. It has good effect on controlling cable shielding interference and protecting environmental cable in heavy corrosion.

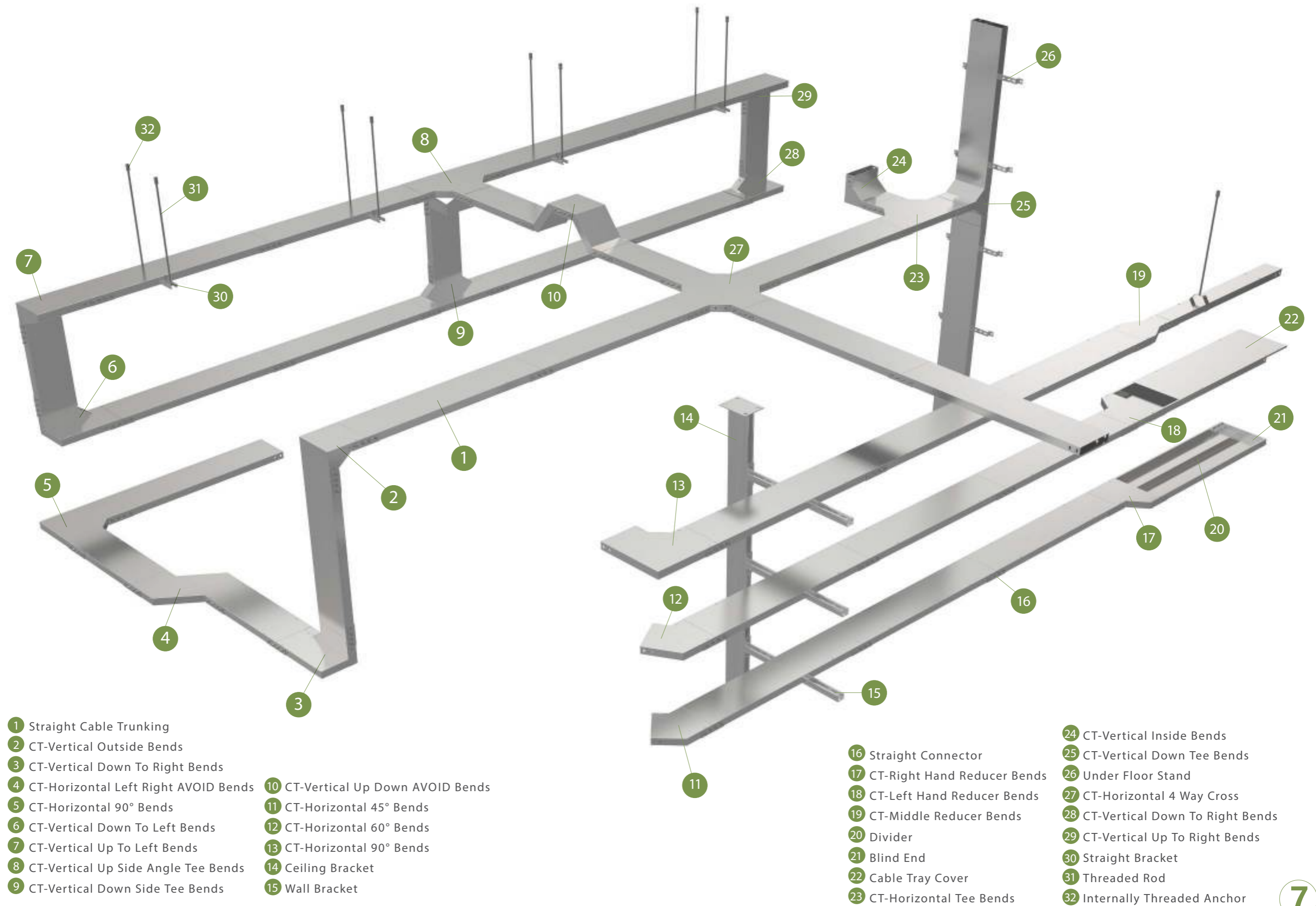



Model: Cable Trunking - CT				*Cover Optional	
Model-Code-Height-Width	H (mm)	W (mm)	L (mm)	Materials And Finishes	
CT-50-50	50	50	2000/3000	G	Galvanized Steel DX51D-Z
CT-50-100	50	100	2000/3000		
CT-50-150	50	150	2000/3000		
CT-50-200	50	200	2000/3000		
CT-50-250	50	250	2000/3000		
CT-50-300	50	300	2000/3000		
CT-75-100	75	100	2000/3000	HDG	Hot Dip Galvanized After Manufacture
CT-75-200	75	200	2000/3000	EP	Electroplating/Color
CT-75-300	75	300	2000/3000		
CT-100-100	100	100	2000/3000	S	Stainless steel 201/304/316
CT-100-200	100	200	2000/3000	A	Aluminum/Anodizing
CT-100-300	100	300	2000/3000		
CT-100-400	100	400	2000/3000	PC	Powder Coating
CT-100-500	100	500	2000/3000		
CT-150-200	100	200	2000/3000	( If you have any other special requirements, please consult )	
CT-150-300	100	300	2000/3000		
CT-150-400	100	400	2000/3000		
CT-150-500	100	500	2000/3000		
CT-150-600	100	600	2000/3000		
CT-150-800	100	800	2000/3000		



CABLE TRUNKING WELDED  
DIVIDER



CABLE TRUNKING WELD THE  
CABLE FIXING PLATE



CABLE TRUNKING WELDED  
ROUND STEEL

# OB

## PERFORATED Cable Tray

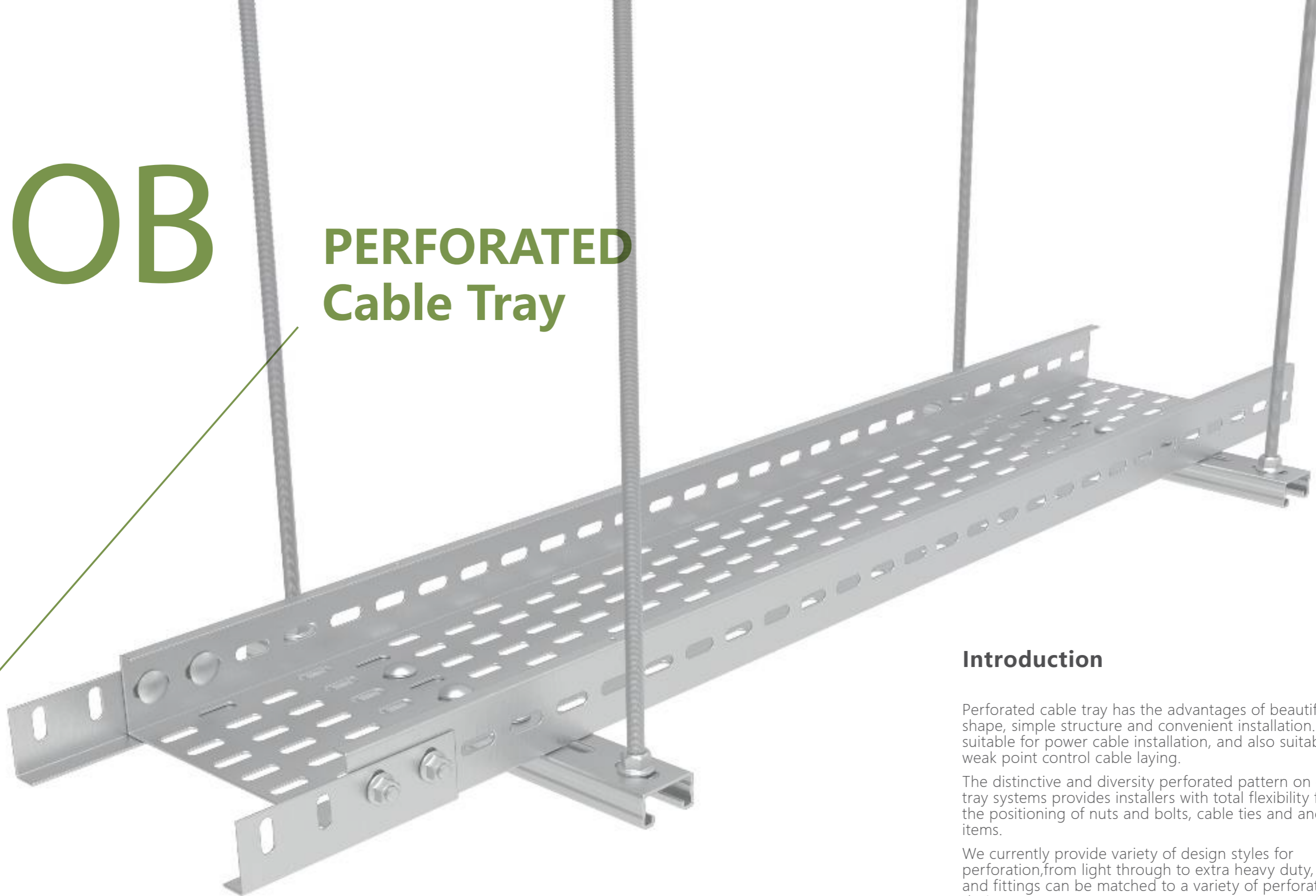

### Introduction

Perforated cable tray has the advantages of beautiful shape, simple structure and convenient installation. It is suitable for power cable installation, and also suitable for weak point control cable laying.

The distinctive and diversity perforated pattern on cable tray systems provides installers with total flexibility for the positioning of nuts and bolts, cable ties and ancillary items.

We currently provide variety of design styles for perforation, from light through to extra heavy duty. Fixings and fittings can be matched to a variety of perforated designs.

Matched with unique adjustable bend and connect accessories to save time and money.

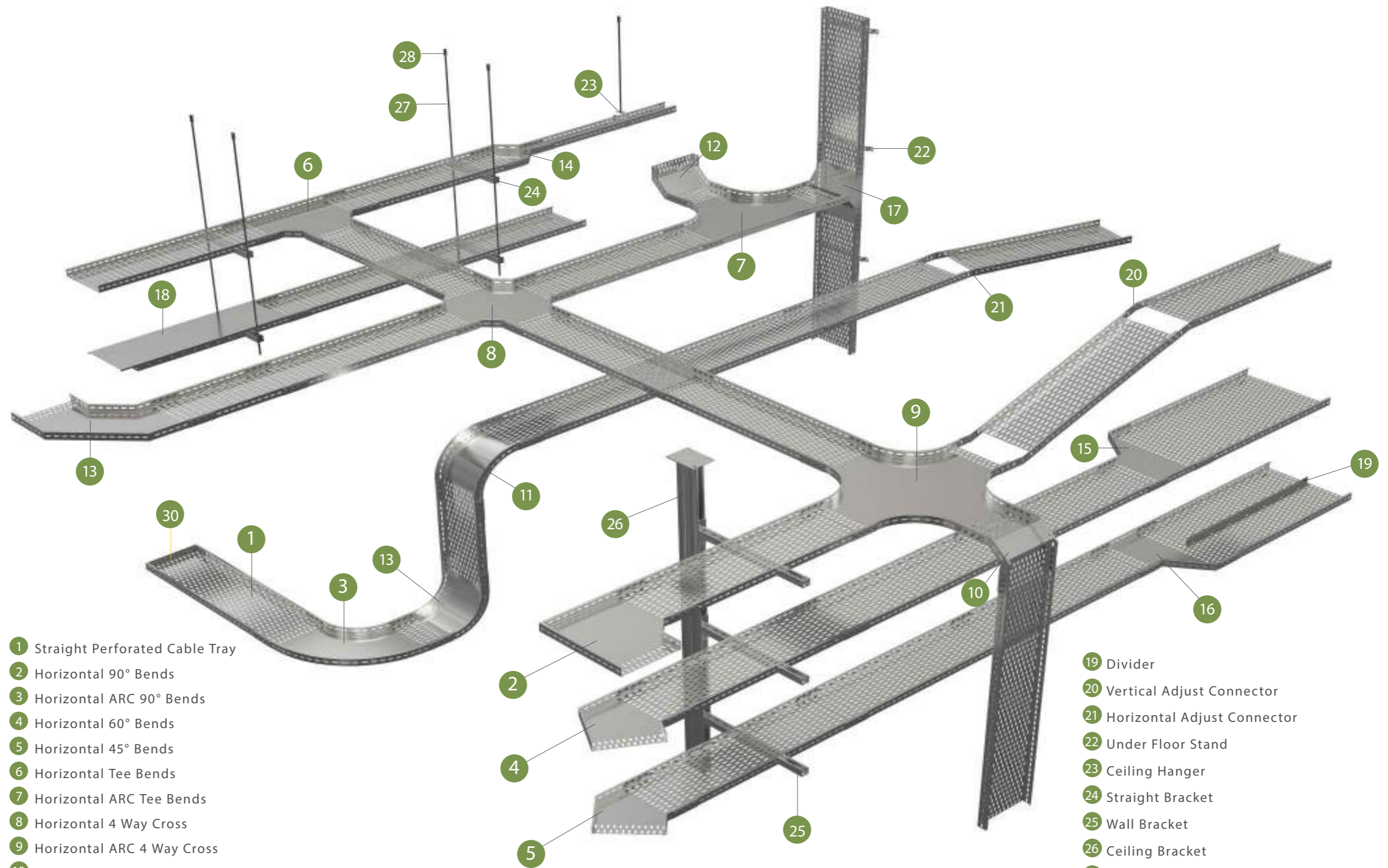

- 1 Straight Perforated Cable Tray
- 2 Horizontal 90° Bends
- 3 Horizontal ARC 90° Bends
- 4 Horizontal 60° Bends
- 5 Horizontal 45° Bends
- 6 Horizontal Tee Bends
- 7 Horizontal ARC Tee Bends
- 8 Horizontal 4 Way Cross
- 9 Horizontal ARC 4 Way Cross
- 10 Vertical Outside Bends
- 11 Vertical ARC Outside Bends
- 12 Vertical Inside Bends
- 13 Vertical ARC Inside Bends
- 14 Middle Reducer Bends

- 15 Left Hand Reducer Bends
- 16 Right Hand Reducer Bends
- 17 Vertical Down Tee Bends
- 18 Cable Tray Cover

- 19 Divider
- 20 Vertical Adjust Connector
- 21 Horizontal Adjust Connector
- 22 Under Floor Stand
- 23 Ceiling Hanger
- 24 Straight Bracket
- 25 Wall Bracket
- 26 Ceiling Bracket
- 27 Threaded Rod
- 28 Internally Threaded Anchor
- 29 Straight Connector
- 30 Blind End

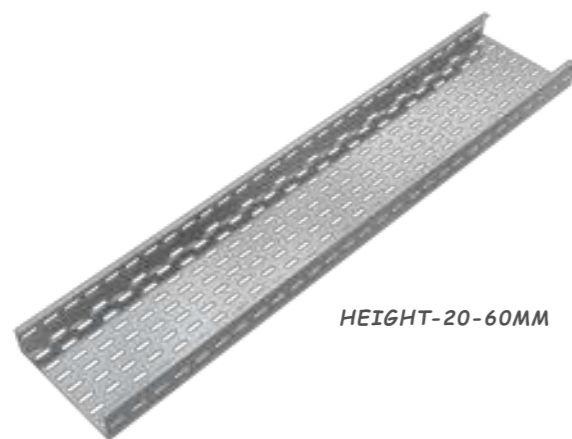

HEIGHT-20-60MM

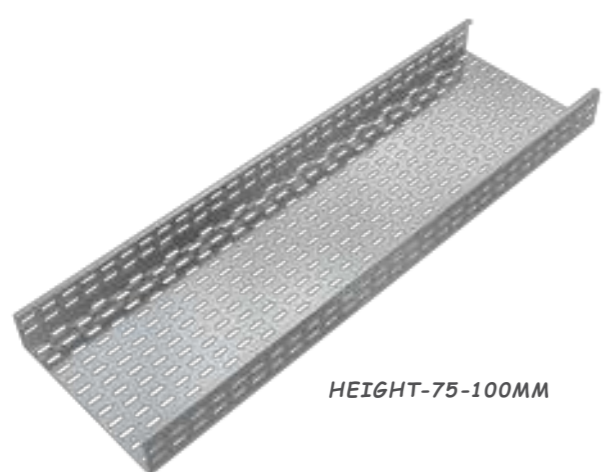

HEIGHT-75-100MM

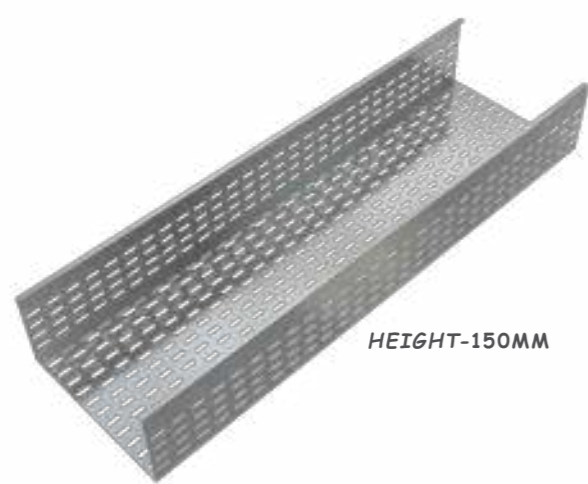

HEIGHT-150MM

Model: SH-1			
Model-Code-Height-Width	H (mm)	W (mm)	L (mm)
SH-1-50-50	50	50	2000/3000
SH-1-50-100	50	100	2000/3000
SH-1-50-150	50	150	2000/3000
SH-1-50-200	50	200	2000/3000
SH-1-50-250	50	250	2000/3000
SH-1-50-300	50	300	2000/3000
SH-1-75-100	75	100	2000/3000
SH-1-75-200	75	200	2000/3000
SH-1-75-300	75	300	2000/3000
SH-1-100-100	100	100	2000/3000
SH-1-100-200	100	200	2000/3000
SH-1-100-300	100	300	2000/3000
SH-1-100-400	100	400	2000/3000
SH-1-100-500	100	500	2000/3000
SH-1-150-200	100	200	2000/3000
SH-1-150-300	100	300	2000/3000
SH-1-150-400	100	400	2000/3000
SH-1-150-500	100	500	2000/3000
SH-1-150-600	100	600	2000/3000
SH-1-150-800	100	800	2000/3000
<b>Materials And Finishes</b> G Galvanized Steel DX51D-Z HDG Hot Dip Galvanized After Manufacture EP Electroplating/Color S Stainless steel 201/304/316 A Aluminum/Anodizing PC Powder Coating ( If you have any other special requirements, please consult )			

Model: DPT			
Model-Code-Height-Width	H (mm)	W (mm)	L (mm)
DPT-50-50	50	50	2000/3000
DPT-50-100	50	100	2000/3000
DPT-50-150	50	150	2000/3000
DPT-50-200	50	200	2000/3000
DPT-50-250	50	250	2000/3000
DPT-50-300	50	300	2000/3000
DPT-75-100	75	100	2000/3000
DPT-75-200	75	200	2000/3000
DPT-75-300	75	300	2000/3000
DPT-100-100	100	100	2000/3000
DPT-100-200	100	200	2000/3000
DPT-100-300	100	300	2000/3000
DPT-100-400	100	400	2000/3000
DPT-100-500	100	500	2000/3000
DPT-150-200	100	200	2000/3000
DPT-150-300	100	300	2000/3000
DPT-150-400	100	400	2000/3000
DPT-150-500	100	500	2000/3000
DPT-150-600	100	600	2000/3000
DPT-150-800	100	800	2000/3000
<b>Materials And Finishes</b> G Galvanized Steel DX51D-Z HDG Hot Dip Galvanized After Manufacture EP Electroplating/Color S Stainless steel 201/304/316 A Aluminum/Anodizing PC Powder Coating ( If you have any other special requirements, please consult )			



HEIGHT-20-60MM



HEIGHT-75-100MM



HEIGHT-150MM

OTHER STYLES

\* For the following models, "D" stands for conventional side height punching and "S" stands for full side height punching.  
( If you have any other special requirements, please consult )

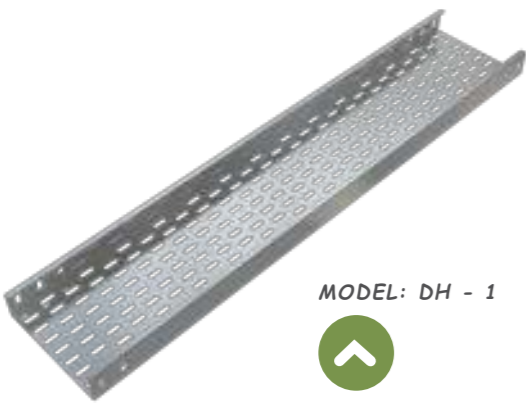

MODEL: DH - 1



MODEL: SMO-1



MODEL: DM - 35



MODEL: SM - 35

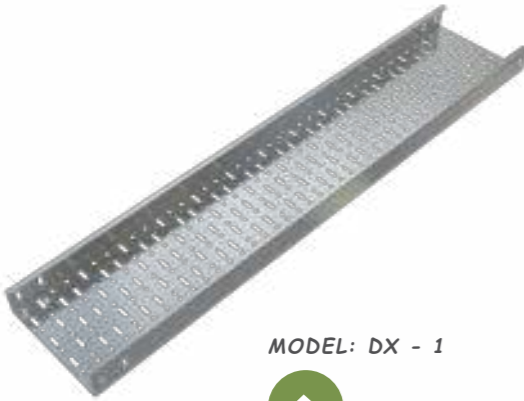

MODEL: DX - 1



MODEL: SYE - 6



Horizontal 90° Bends  
MODEL CODE: SH - 1 - E90

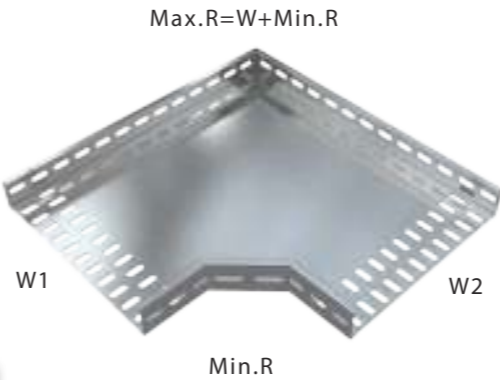

Model-Code-Item Height-Width	H (mm)	W (mm)	Min.R (mm)	Max.R (mm)
SH-1-E90-50-50	50	50	150	200
SH-1-E90-50-100	50	100	150	250
SH-1-E90-50-200	50	200	150	350
SH-1-E90-100-200	100	200	150	250
SH-1-E90-100-300	100	300	150	450
SH-1-E90-100-400	100	400	150	550
SH-1-E90-100-500	100	500	150	650
SH-1-E90-150-300	150	300	150	450
SH-1-E90-150-400	150	400	150	550
SH-1-E90-150-600	150	600	150	750
SH-1-E90-150-750	150	750	150	900

Model-Code-Item Height-Width	H (mm)	W (mm)	Min.R (mm)	Max.R (mm)
SH-1-AE90-50-50	50	50	300	350
SH-1-AE90-50-100	50	100	300	400
SH-1-AE90-50-200	50	200	300	500
SH-1-AE90-100-200	100	200	300	500
SH-1-AE90-100-300	100	300	300	600
SH-1-AE90-100-400	100	400	300	700
SH-1-AE90-100-500	100	500	300	800
SH-1-AE90-150-300	150	300	300	600
SH-1-AE90-150-400	150	400	300	700
SH-1-AE90-150-600	150	600	300	600
SH-1-AE90-150-750	150	750	300	1050



Horizontal ARC 90° Bends  
MODEL CODE: SH - 1 - AE90

# OC

## CABLE LADDER

### Introduction

Cable ladder is made of two long straight rods and a man-made welded cross bar in the middle. The shape is like a ladder. The design of the middle cross bar is specially designed in this way, because it can strengthen the bearing capacity and stability of the cable ladder, and the shape of the ladder can also have good heat dissipation and fire prevention. In the use of installation and laying, if the cable inside the cable ladder is faulty, it can also allow the maintenance personnel to quickly find out the location of the problem, and effectively and quickly do the corresponding protective measures.

Cable ladder is used for laying large diameter cable lines, especially suitable for laying high voltage and low voltage cable lines.

- 1 Straight Cable Ladder - CL
- 2 CL-Horizontal ARC 90° Bends
- 3 CL-Vertical Inside Bends
- 4 CL-Vertical Outside Bends
- 5 Horizontal 4 Way Cross
- 6 CL-Vertical ARC Inside Bends
- 7 CL-Vertical ARC Outside Bends
- 8 CL-Horizontal Tee Bends
- 9 Straight Bracket
- 10 Threaded Rod
- 11 Internally Threaded Anchor
- 12 CL-Horizontal 90° Bends
- 13 CL-Horizontal 60° Bends
- 14 CL-Horizontal 45° Bends

- 15 CL-Vertical Adjustable Angle Bends
- 16 Blind End
- 17 CL-Horizontal ARC Tee Bends
- 18 Under Floor Stand
- 19 CL-Vertical Down Tee Bends
- 20 Ceiling Bracket
- 21 Wall Bracket
- 22 CL-Right Hand Reducer Bends
- 23 CL-Middle Reducer Bends
- 24 CL-Left Hand Reducer Bends
- 25 CL-Horizontal ARC 4 Way Cross

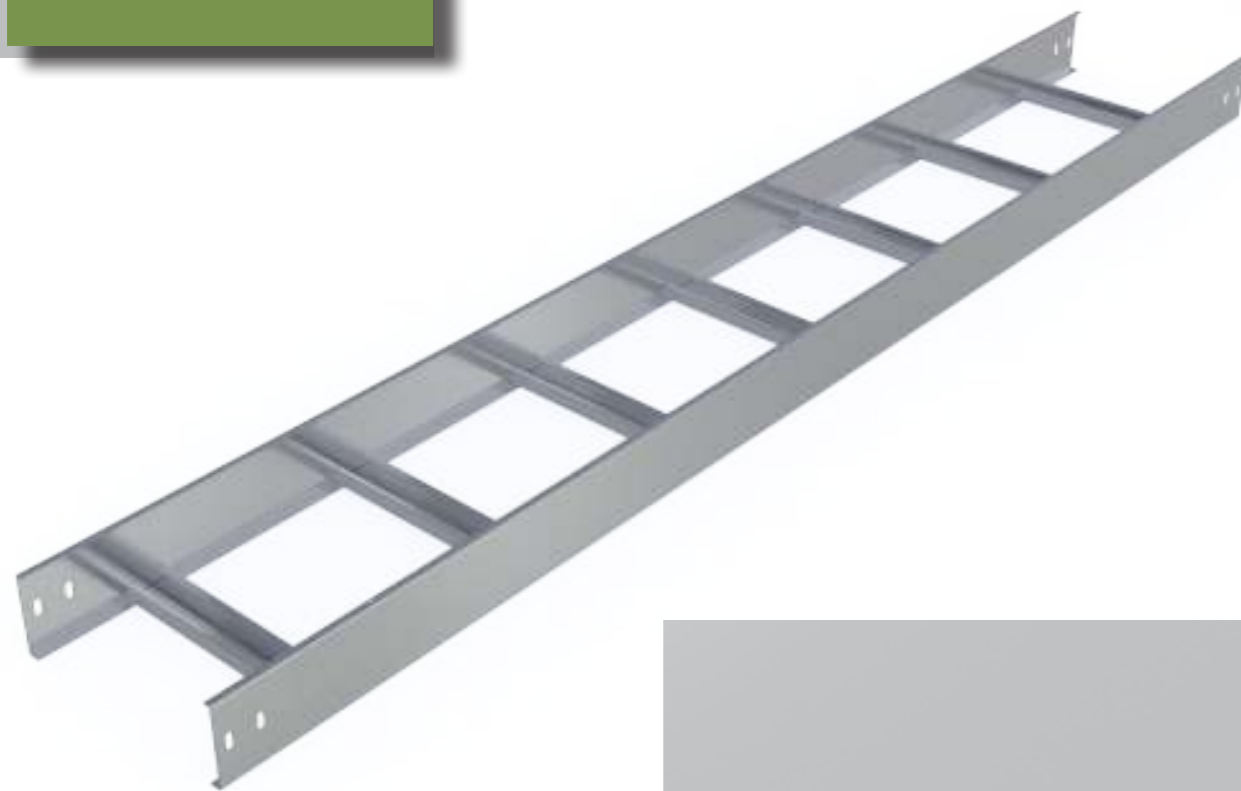

Model: Cable Ladder - CL				*Cover Optional
Model-Code-Height-Width	H (mm)	W (mm)	L (mm)	Materials And Finishes
CL-50-50	50	50	2000/3000	<div> <div>G</div> <div>Galvanized Steel DX51D-Z</div> </div> <div> <div>HDG</div> <div>Hot Dip Galvanized After Manufacture</div> </div> <div> <div>EP</div> <div>Electroplating/Color</div> </div> <div> <div>S</div> <div>Stainless steel 201/304/316</div> </div> <div> <div>A</div> <div>Aluminum/Anodizing</div> </div> <div> <div>PC</div> <div>Powder Coating</div> </div> <div> <div>( If you have any other special requirements, please consult )</div> </div>
CL-50-100	50	100	2000/3000	
CL-50-150	50	150	2000/3000	
CL-50-200	50	200	2000/3000	
CL-50-250	50	250	2000/3000	
CL-50300	50	300	2000/3000	
CL-75-100	75	100	2000/3000	
CL-75-200	75	200	2000/3000	
CL-75-300	75	300	2000/3000	
CL-100-100	100	100	2000/3000	
CL-100-200	100	200	2000/3000	
CL-100-300	100	300	2000/3000	
CL-100-400	100	400	2000/3000	
CL-100-500	100	500	2000/3000	
CL-150-200	100	200	2000/3000	
CL-150-300	100	300	2000/3000	
CL-150-400	100	400	2000/3000	
CL-150-500	100	500	2000/3000	
CL-150-600	100	600	2000/3000	
CL-150-800	100	800	2000/3000	



CABLE LADDER WITH HIGH SIDE REINFORCEMENT



PERFORATED CABLE LADDER



CABLE LADDER WITH REVERSE SIDE HEIGHT



MODEL II SUPPORT



HK STYLE SUPPORT



A TYPE HANGING

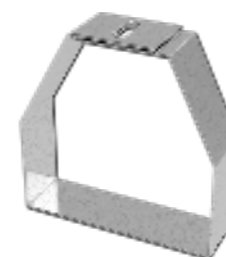

B TYPE HANGING



C TYPE HANGING



SUPPORT



HK STYLE CEILING HANGING



EARTH GROUNDING COPPER SHEET



EARTH EARTHED COPPER TAPE



BASE SUPPORT



C CHANNEL SUPPORT



COVER LOCK



COVER CLAMP

LICENSE & AGGREMENT



Factory B2 Lot 3, Panbil Industrial Estate, Kel. Muka Kuning,  
Kec. Sei Beduk, Kota Batam, Prov Kepulauan Riau  
VERTEXPLASTIKINDONESIA@GMAIL.COM